

# CHIMNEY MOUNT

## INSTALLATION

PROPER INSTALLATION IS IMPORTANT. IF YOU NEED ASSISTANCE, CONSULT A CONTRACTOR, ELECTRICIAN OR TELEVISION ANTENNA INSTALLER (CHECK WITH YOUR LOCAL BUILDING SUPPLY, OR HARDWARE STORE FOR REFERRALS).

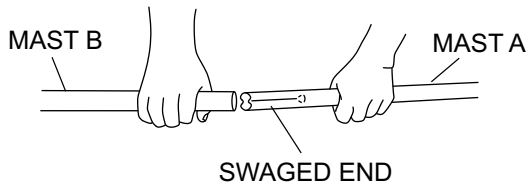
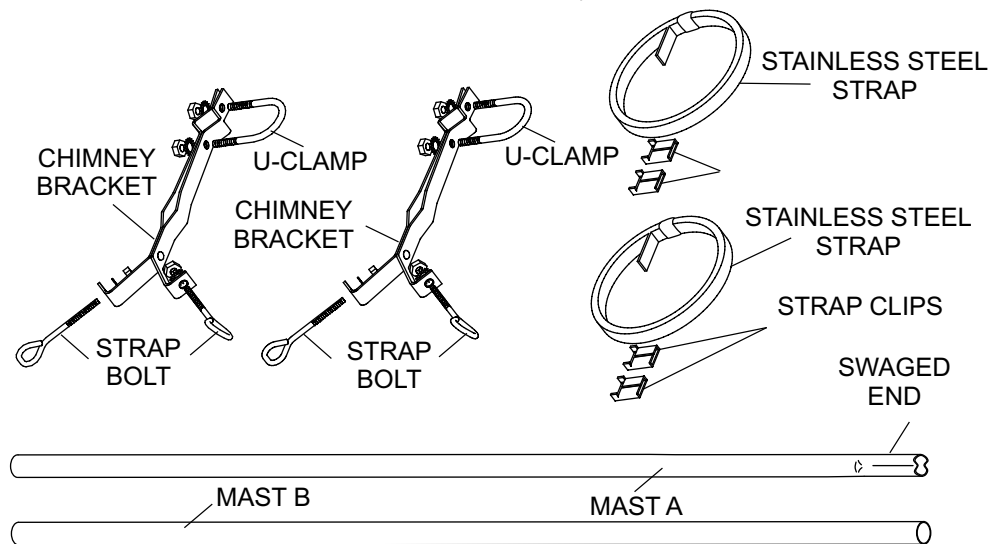
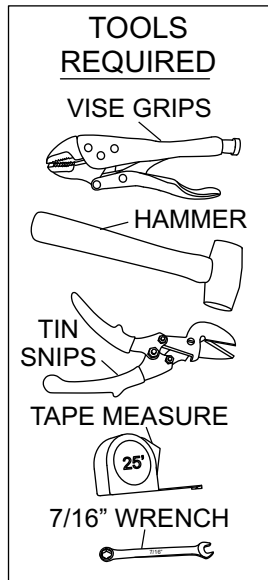

1

Slip the swaged end of mast A into the round end of mast B.

2

Tap the two sections together with a hammer. A piece of wood will protect the end from damage.

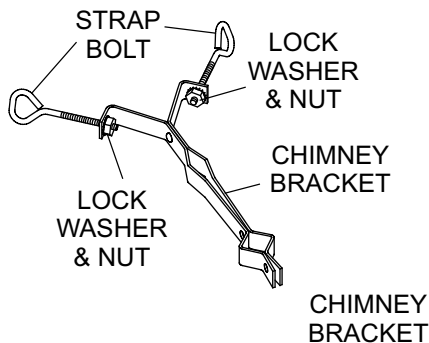
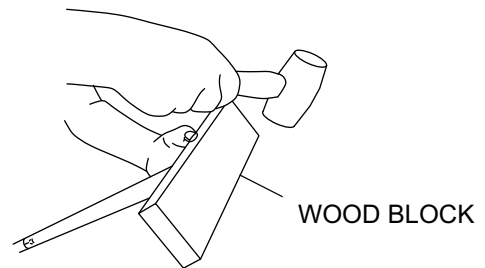

3

Insert all four strap bolts into chimney bracket holes, securing approximately 1/4" thru external lock washers into nuts. **\*Do not tighten any further at this time\*.**

4a

Feed the strap through a strap clip as shown and up through the strap bolt.

4b

Bend the strap and insert it back through the strap clip.

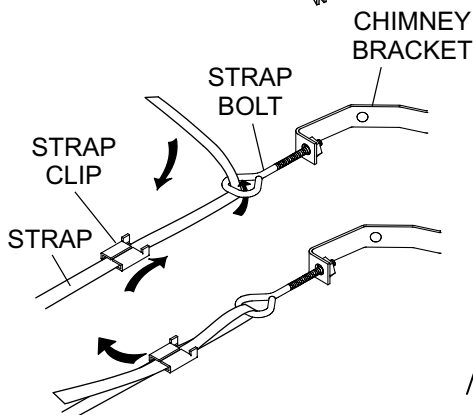

**MAXIMUM** INC

30 Samuel Barnet Blvd.  
New Bedford, MA 02745  
(508) 995-2200

# CHIMNEY MOUNT

## INSTALLATION

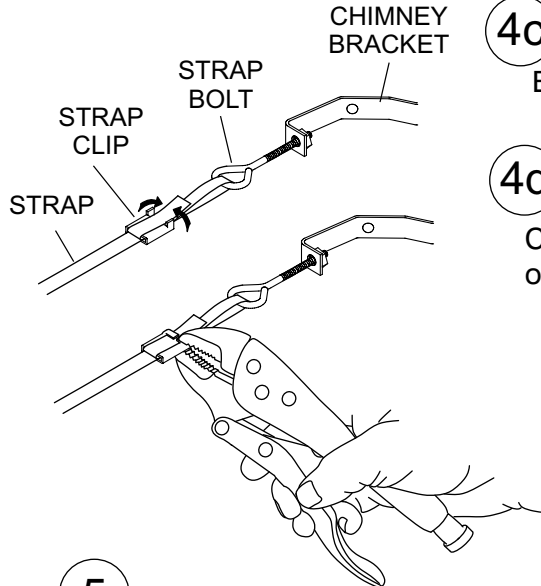

4c

Bend the strap back over the strap clip.

4d

Crimp the tabs of the strap clip securely over the strap.

5

Feed the stainless straps around the chimney without twisting them. Repeat steps 4a-4d to secure the loose strap ends to the brackets. Cut off any excess material once secure. Brackets should be at least 18" apart for proper mast support.

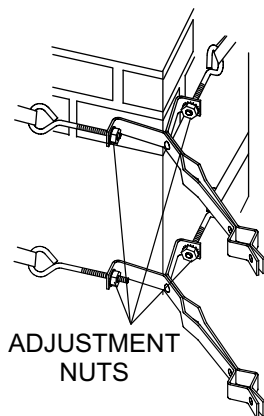
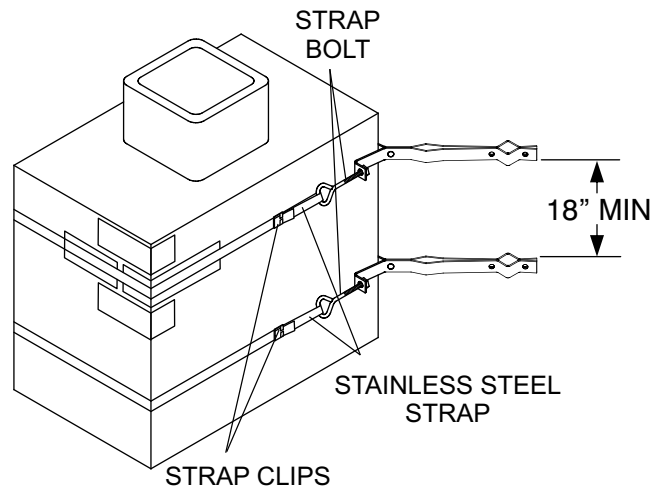

6

Tighten the stainless steel straps with the adjustment nuts at the ends of the strap bolts. Make sure straps are centered on bricks and not mortar.

7

Insert the bottom of the mast into the chimney brackets and secure with the U-clamps.

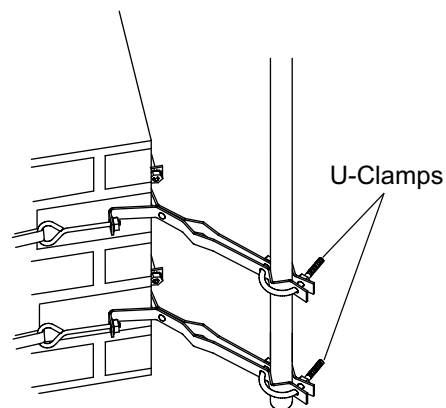

**MAXIMUM**<sub>INC</sub>

30 Samuel Barnet Blvd.  
New Bedford, MA 02745  
(508) 995-2200

Page 2